



The Best Records Protection You Can Buy





# YOU CAN'T DO ANYTHING TO STOP FIRES, TORNADOES OR THEFT FROM DESTROYING YOUR BUSINESS.

## OR CAN YOU?

An unforeseen disaster can do serious damage to your business. Because, while your company can always find a new building, you won't be able to reconstruct damaged or destroyed vital records. In fact, research shows that 90% of all businesses that suffer a catastrophic fire and lose their vital records go out of business within two years. Which is why it's 100% necessary to protect your business's crucial documents and data. Fortunately, **FireKing®** fireproof file cabinets and data safes provide the very highest level of protection from fires, impact damage, theft, and even explosions.

Our philosophy has always been "Why risk it?" That's why FireKing has worked tirelessly for over half a century to develop the absolute best records protection available on the market.



The Best Records Protection You Can Buy

**PRODUCT CATALOG**

**1**

# CONTENTS



- 5** FIREKING® VERTICAL AND LATERAL FILES
- 7** FIREKING 25® AND TURTLE® FILES
- 8** FIREKING® PROTECTION PLUS™  
AND TWO-HOUR VERTICAL FILES
- 9** FIREKING® CARD, CHECK AND NOTE FILES  
AND STORAGE CABINET



- 10** FILE COLORS AND FEATURES
- 11** SIGNATURE SERIES  
FILE CABINETS
- 12** FILE ACCESSORIES
- 13** FILE SPECIFICATIONS

- 16** UL® ONE-HOUR AND TWO-HOUR FIRE SAFES
- 17** UL® ONE-HOUR FIRE AND BURGLARY SAFES
- 18** UL® TWO-HOUR FIRE WITH IMPACT AND BURGLARY SAFES
- 19** FIREKING® MIXED MEDIA SAFE / FIREKING® MEDIAVAULT™
- 20** FIREKING® ONE- AND TWO-HOUR DATA SAFES
- 21** FIREKING® THREE-HOUR DATA SAFES
- 22** GARY® BY FIREKING® DEPOSITORY AND EXECUTIVE SAFES
- 23** GARY® BY FIREKING® PERSONAL, LAPTOP AND TRIM SAFES
- 25** UL® SAFETY RATINGS

# WHAT ARE YOUR MOST IMPORTANT DOCUMENTS? HOW WOULD LOSING THESE DOCUMENTS AFFECT YOUR BUSINESS? WHAT ARE YOU DOING TO PROTECT THEM?

## THE RIGHT FIREPROOF FILE IS NOT JUST THE ANSWER. IT'S A SERIES OF QUESTIONS.

Tax records. Customer lists. Accounts payable and receivable. Insurance policies. Computer records. Deeds, titles and licenses. Before you can decide how to best protect them, you need to ask yourself some hard questions.

But there's one question you don't have to ask: What brand of fireproof file should I buy?

**FireKing®** has been building fireproof files of unsurpassed quality for over 50 years. Our state-of-the-art manufacturing facility builds tens of thousands of FireKing files for business, government, financial and personal use every year.

We understand that documents are only truly safe if they can withstand both fire and forceful impact. That's why our products carry the prestigious Underwriters Laboratories® (UL®) Class 350 1-hour Insulated Records Container rating – which means they have passed the UL® 1700° fire endurance test and a 2000° explosion hazard test. Our files must also withstand

an exceptional 30-foot drop/impact test to ensure unique and maximum protection. Also, we offer the industry's only UL-rated 2-hour file cabinet. The quality built into every FireKing file cabinet is the very best. And we back up our quality claims with a 3-year product warranty and free replacement guarantee.

Our **3-year warranty** on all mechanical or operable parts ensures that if a part malfunctions or breaks down during normal use, we will either repair or replace the part. Associated labor costs for the repair or replacement of these parts will be paid by FireKing for three years from the date of purchase.

With our **free replacement guarantee**, if a FireKing file cabinet sustains any damage while protecting records from a fire, we will replace it free of charge.

For protecting your valuable information and your peace of mind, FireKing files are the best records protection you can buy.

Look for these icons when choosing the right product for your business:



Underwriters Laboratories  
Class 350 1-hr. Insulated  
Records Container



Underwriters Laboratories  
Class 350 2-hr. Insulated  
Records Container



Underwriters Laboratories  
Class 125 Rating Insulated  
Records Protection for  
Computer Media



Underwriters Laboratories  
Explosion Hazard Rating

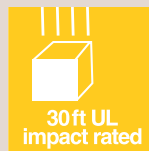

Underwriters Laboratories  
Impact Rating



Medeco® Key Lock  
Underwriters Laboratories  
Listed to resist picking  
and drilling



All FireKing files are  
designed to prevent water  
damage resulting from  
sprinklers and fire hoses



Underwriters Laboratories  
RSC Burglary Rating



Theft Resistant



## FIREKING® VERTICAL FILES

**4-2131-C**  
*Legal size/Shown in Parchment*



**2-2131-C**



## FIREKING® LATERAL FILES

**4-3822-C**  
*Shown in Black*



**2-3822-C**



### FIREKING® VERTICAL FILES

FireKing Vertical 31"-deep Files add a lot of protection to any office. For a modest one-time investment, you'll rest easier knowing that FireKing's most popular fireproof files are protecting your business. Vertical files are available in 2-, 3- and 4-drawer sizes, as well as letter and legal widths. A UL®-listed high-security Medeco® lock is standard. A variety of additional locking options are available. Choose from 9 standard colors (or any custom color you specify) to match your office décor perfectly. A complete range of accessory and interior options are also offered. Keep your records safe and on-hand with UL Class 350 1-hour fire protection that carries FireKing's 3-year warranty. The exact style you want and the peace of mind you need.

### FIREKING® LATERAL FILES

Our Lateral Files offer you all the features of our Vertical Files in a sleek design. They're fully equipped to handle both letter and legal hanging files—no additional frames are required.\* They're available in 31", 38" and 44" widths in 2-, 3- and 4-drawer models, with a UL-listed Medeco key lock. Additional locking options are available. And like our vertical files, they're available in 9 standard colors or any custom color you specify. Peace of mind that fits your office and your sense of style.

*\*An additional hanger bar is required for filing letter-size files side-to-side.*





## FIREKING 25®

**4-2125-C**  
*Legal size/Shown in Platinum*



**2-2125-C**  
*Legal size*



## FIREKING TURTLE®

**4R1822-C**  
*Shown in Parchment*



**2R1822-C**  
*Shown in Parchment*



*Letter- and legal-sized documents*

*can be filed in a Turtle.*

- *Letter – front-to-back*
- *Legal – side-to-side*

### FIREKING 25®

FireKing 25 files provide your important records with the protection they need while economizing your space and budget. All the benefits of our larger-sized FireKing files in a competitively priced, 25"-deep size. Available in 2- or 4-drawer models and letter or legal widths. All FireKing 25 files are equipped with a UL®-listed, high-security Medeco® key lock, and are available in 9 standard colors.

*Follower blocks for FireKing 25 files are sold separately.*

### FIREKING TURTLE®

Don't spend money duplicating or replacing your valuable records. Just get a Turtle. For safeguarding your irreplaceable records and documents, no other 22"-deep file gives you as much protection as the extra-tough Turtle from FireKing. Both letter- and legal-sized documents can be filed in a Turtle. The Turtle offers UL 1-hour fire protection with impact rating. Each one comes with a standard 4-pin key lock and our exclusive 3-year warranty. It's perfect for your home, personal office or small business. Available in Parchment color only. Three years of security at an affordable price.

## FIREKING® PROTECTION PLUS™

### SAFE-IN-A-FILE

4-2131-CSF

*Shown in Parchment*



### ELECTRONIC LOCK FILE

4-2131-CEL

*Shown in Parchment*



## FIREKING® TWO-HOUR FILE

### TWO-HOUR FILE

4-2157-2

*Shown in Parchment*



*Protection Plus with combination lock*



*Protection Plus Safe-In-A-File*



*3 file drawers*

## FIREKING® PROTECTION PLUS™

For additional security, we offer the Protection Plus Safe-In-A-File and the Protection Plus Electronic Lock File. The exterior is available in 9 standard colors.

### Protection Plus Safe-In-A-File Features

- 2.4 cubic foot capacity
- Inner safe door constructed of 1/4" steel
- Safe features internal relocking device
- Both safe and file drawers offer fireproof protection
- UL®-listed Group II combination lock
- Safe interiors are available in Parchment color only

### Protection Plus Electronic Lock File Features

- Six-digit combination code for quick opening
- Master code and up to 8 different user codes
- User code can be changed or deleted in seconds
- Drawers lock automatically when closed to ensure document security
- UL-listed Group II combination lock with internal relocking device

## FIREKING® 2-HOUR VERTICAL FILES

The ultimate in fireproof records protection. These are the only American-built insulated files with a 2-hour fire and impact rating from Underwriters Laboratories®. That's because they are made with Thermocell II®, a proprietary insulation which provides twice the protection. Available in both letter and legal sizes. A UL-listed, high-security Medeco® key lock comes standard. Nine standard colors to choose from. Vertical files also come in custom colors and are available in 2-, 3- or 4-drawer models.

## FIREKING® CARD, CHECK AND NOTE FILE

6-2552-C

*Shown in Parchment*



4-2536-C



*Shown with 3206 Inserts (sold separately)*

## FIREKING® STORAGE CABINET

CF7236-F



CF4436-F



### FIREKING® CARD, CHECK AND NOTE FILES

Available in 4- and 6-drawer models. All models come with a UL® 1-hour fire and impact rating. All Card, Check and Note Files feature a UL-listed, high-security Medeco® key lock. A wide variety of additional locking options are available to secure confidentiality. Plus, these files offer the option of 2- or 3-section inserts and card trays to allow you the flexibility your filing systems require. They come in 9 standard colors or any custom color you specify.

### FIREKING® STORAGE CABINET

Because oversized documents, binders, end-tab filing, Banker's Box®, and other valuable items need fire protection too, there's the new fire-resistant FireKing® Storage Cabinet. Both the 72" four-shelf model and the 44" two-shelf model are equipped with a weight capacity of 160 lbs. per shelf, high-security Medeco® key locks that resist picking and drilling, plus scratch-resistant Parchment powder coat finishes for a lifetime of protection inside and out. They are also available with an Electronic Lock option. The FireKing Storage Cabinet comes with a UL Class 325 ½-hour fire rating.

## COLORS

FireKing® Vertical, Lateral, FireKing 25®, and Card, Check and Note Files are available in the 9 standard colors preferred by today's office designers and decorators: Parchment, Champagne, Tan, Sand, Platinum, Brown, Taupe, Pewter, and Black.

Turtle® Files are available in Parchment only.

To aid your selection, your FireKing dealer will be glad to show you color charts. Custom colors are also available.

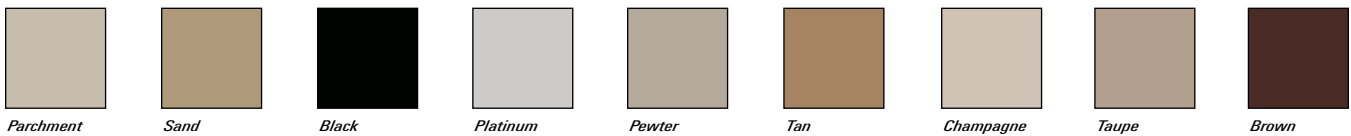

## FILE FEATURES

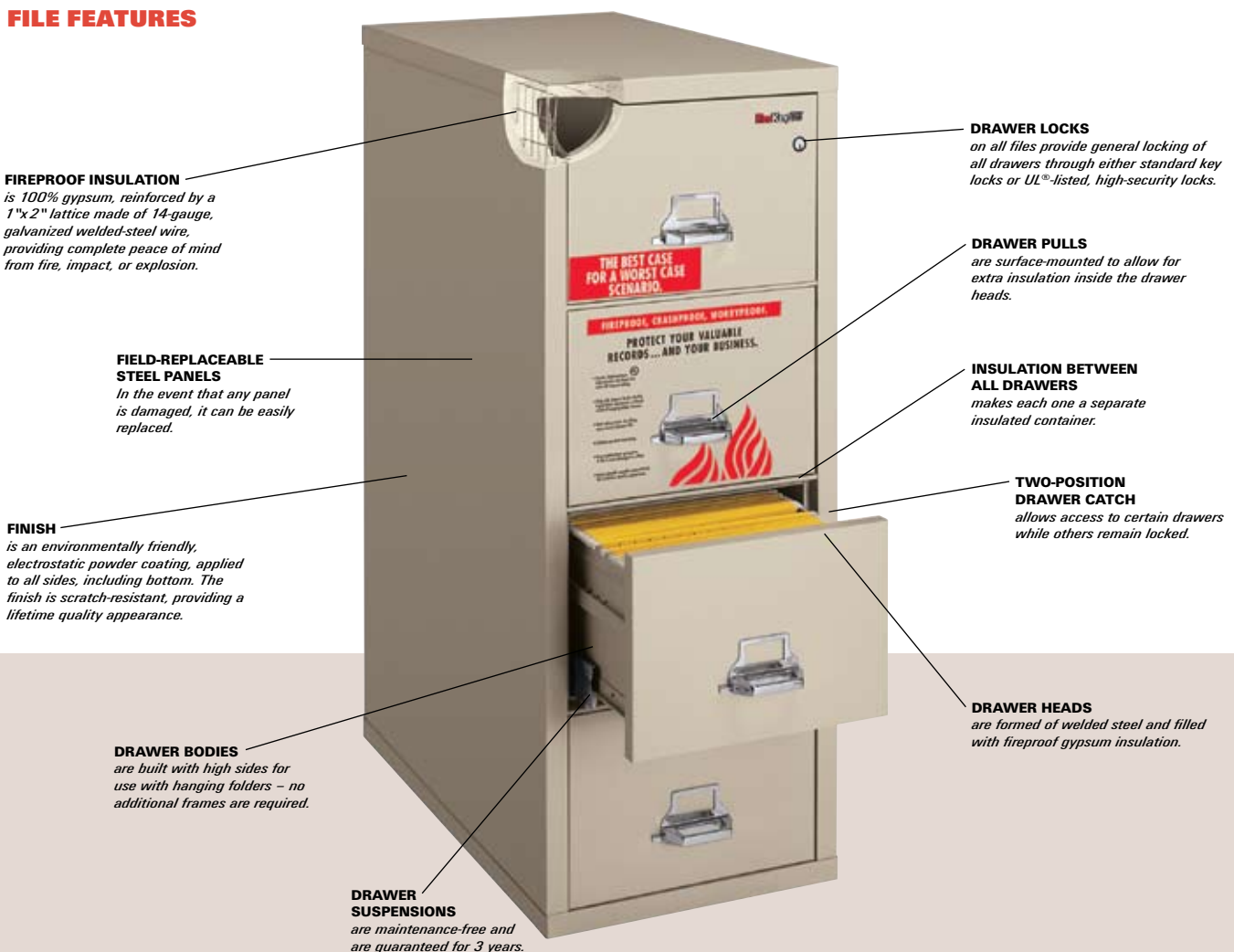

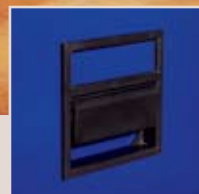

*Recessed  
Designer  
Handles*

## **SIGNATURE SERIES VERTICAL AND LATERAL FILES**

FireKing® Signature Series file cabinets offer the maximum in efficient, space-saving capacity. Available in vertical and lateral models, all come with the quality construction and design features that make FireKing your best choice in fire-resistant cabinets.

- Exclusive powder coat finish for superior scratch, scuff, and stain resistance
- Accuride drawer suspensions are guaranteed for 3 years
- Field replaceable exterior steel skins
- UL®-listed Medeco® high-security locks in a variety of key and lock arrangements
- Nine standard colors
- Match any color you choose for an additional cost

FireKing Signature Series vertical files feature drawers with 1<sup>3</sup>/<sub>8</sub>" extra clearance to accept the largest types of documents – international style A-4, box files, binders, foolscap, ledger and folio sizes.





## ACCESSORIES

You have many options to customize any of our fireproof file cabinets. You can add security features as well as accessories that will help you tailor your file cabinet to your document types.

### CASTERS

Make your FireKing® file portable with a caster base.



### CROSS TRAY

Cross Trays sit horizontally or vertically across a standard file drawer and are great for storing small items, cards, checks, etc.



### INNER DRAWER

The Inner Drawer accessory fits inside standard file drawers and comes complete with glide rails for smooth operation.



### DOCUMENT INSERTS

Opt for Document Inserts and provide a convenient way to file various non-standard size documents, a Top Inner Drawer (factory installed) or Section Inserts with 1 to 6 sections.



### FILE LOCK OPTIONS

Electronic Locks are available for most FireKing files. Specify one e-lock for the cabinet or order your file with e-locks on each drawer. (Turtle® files are equipped with standard key locks.)

## SPECIFICATIONS

### FIREKING® TURTLE®



Catalog No.	Description	Inside Dimensions			Outside Dimensions			Approx. Shipping Wt.
		H	W	D	H	W	D	
4R1822-C	4 Drawer Vertical	10 $\frac{3}{8}$ "	12 $\frac{3}{16}$ "	15 $\frac{1}{8}$ "	52 $\frac{3}{4}$ "	17 $\frac{3}{4}$ "	22 $\frac{1}{8}$ "	435 lbs.
2R1822-C	2 Drawer Vertical	10 $\frac{3}{8}$ "	12 $\frac{3}{16}$ "	15 $\frac{1}{8}$ "	27 $\frac{3}{4}$ "	17 $\frac{3}{4}$ "	22 $\frac{1}{8}$ "	251 lbs.

*Turtles: A space-saving file 22" deep that holds letter-size hanging folders front-to-back and legal-size hanging folders side-to-side.*

*Turtles are available in Parchment color only. Turtle files are equipped with four-pin key lock only. Lock accessories not available on Turtle files.*

### FIREKING® VERTICAL FILES



4-1831-C	4 Drawer Letter	10 $\frac{3}{8}$ "	12 $\frac{3}{16}$ "	26"	52 $\frac{3}{4}$ "	17 $\frac{3}{4}$ "	31 $\frac{1}{16}$ "	603 lbs.
4-2131-C	4 Drawer Legal	10 $\frac{3}{8}$ "	15 $\frac{1}{4}$ "	26"	52 $\frac{3}{4}$ "	20 $\frac{13}{16}$ "	31 $\frac{1}{16}$ "	664 lbs.
3-1831-C	3 Drawer Letter	10 $\frac{3}{8}$ "	12 $\frac{3}{16}$ "	26"	40 $\frac{1}{4}$ "	17 $\frac{3}{4}$ "	31 $\frac{1}{16}$ "	476 lbs.
3-2131-C	3 Drawer Legal	10 $\frac{3}{8}$ "	15 $\frac{1}{4}$ "	26"	40 $\frac{1}{4}$ "	20 $\frac{13}{16}$ "	31 $\frac{1}{16}$ "	526 lbs.
2-1831-C	2 Drawer Letter	10 $\frac{3}{8}$ "	12 $\frac{3}{16}$ "	26"	27 $\frac{3}{4}$ "	17 $\frac{3}{4}$ "	31 $\frac{1}{16}$ "	348 lbs.
2-2131-C	2 Drawer Legal	10 $\frac{3}{8}$ "	15 $\frac{1}{4}$ "	26"	27 $\frac{3}{4}$ "	20 $\frac{13}{16}$ "	31 $\frac{1}{16}$ "	383 lbs.

### FIREKING® LATERAL FILES



4-3122-C	4 Drawer	10 $\frac{3}{8}$ "	25 $\frac{3}{16}$ "	15 $\frac{1}{8}$ "	52 $\frac{3}{4}$ "	31 $\frac{3}{16}$ "	22 $\frac{1}{8}$ "	794 lbs.
4-3822-C	4 Drawer	10 $\frac{3}{4}$ "	31 $\frac{15}{16}$ "	15 $\frac{1}{8}$ "	52 $\frac{3}{4}$ "	37 $\frac{1}{2}$ "	22 $\frac{1}{8}$ "	907 lbs.
4-4422-C	4 Drawer	10 $\frac{3}{4}$ "	38 $\frac{15}{16}$ "	15 $\frac{1}{8}$ "	52 $\frac{3}{4}$ "	44 $\frac{1}{2}$ "	22 $\frac{1}{8}$ "	1,019 lbs.
3-3122-C	3 Drawer	10 $\frac{3}{8}$ "	25 $\frac{3}{16}$ "	15 $\frac{1}{8}$ "	40 $\frac{1}{4}$ "	31 $\frac{3}{16}$ "	22 $\frac{1}{8}$ "	574 lbs.
3-3822-C	3 Drawer	10 $\frac{3}{4}$ "	31 $\frac{15}{16}$ "	15 $\frac{1}{8}$ "	40 $\frac{1}{4}$ "	37 $\frac{1}{2}$ "	22 $\frac{1}{8}$ "	756 lbs.
3-4422-C	3 Drawer	10 $\frac{3}{4}$ "	38 $\frac{15}{16}$ "	15 $\frac{1}{8}$ "	40 $\frac{1}{4}$ "	44 $\frac{1}{2}$ "	22 $\frac{1}{8}$ "	791 lbs.
2-3122-C	2 Drawer	10 $\frac{3}{8}$ "	25 $\frac{3}{16}$ "	15 $\frac{1}{8}$ "	27 $\frac{3}{4}$ "	31 $\frac{3}{16}$ "	22 $\frac{1}{8}$ "	456 lbs.
2-3822-C	2 Drawer	10 $\frac{3}{4}$ "	31 $\frac{15}{16}$ "	15 $\frac{1}{8}$ "	27 $\frac{3}{4}$ "	37 $\frac{1}{2}$ "	22 $\frac{1}{8}$ "	532 lbs.
2-4422-C	2 Drawer	10 $\frac{3}{4}$ "	38 $\frac{15}{16}$ "	15 $\frac{1}{8}$ "	27 $\frac{3}{4}$ "	44 $\frac{1}{2}$ "	22 $\frac{1}{8}$ "	584 lbs.

*Laterals: Multi-purpose lateral files designed for letter and legal filing. Fully equipped for letter and legal hanging folders.*

### FIREKING 25®



4-1825-C	4 Dr Letter 25" Deep	10 $\frac{3}{8}$ "	12 $\frac{3}{16}$ "	19 $\frac{3}{4}$ "	52 $\frac{3}{4}$ "	17 $\frac{3}{4}$ "	25 $\frac{1}{16}$ "	508 lbs.
4-2125-C	4 Dr Legal 25" Deep	10 $\frac{3}{8}$ "	15 $\frac{1}{4}$ "	19 $\frac{3}{4}$ "	52 $\frac{3}{4}$ "	20 $\frac{13}{16}$ "	25 $\frac{1}{16}$ "	551 lbs.
2-1825-C	2 Dr Letter 25" Deep	10 $\frac{3}{8}$ "	12 $\frac{3}{16}$ "	19 $\frac{3}{4}$ "	27 $\frac{3}{4}$ "	17 $\frac{3}{4}$ "	25 $\frac{1}{16}$ "	287 lbs.
2-2125-C	2 Dr Legal 25" Deep	10 $\frac{3}{8}$ "	15 $\frac{1}{4}$ "	19 $\frac{3}{4}$ "	27 $\frac{3}{4}$ "	20 $\frac{13}{16}$ "	25 $\frac{1}{16}$ "	326 lbs.

### FIREKING® 2-HOUR VERTICAL FILES



4-1956-2	4 Drawer Letter	11 $\frac{1}{16}$ "	12 $\frac{15}{16}$ "	25 $\frac{1}{8}$ "	56 $\frac{3}{16}$ "	19"	31 $\frac{1}{16}$ "	957 lbs.
4-2157-2	4 Drawer Legal	11 $\frac{13}{16}$ "	15 $\frac{1}{4}$ "	26"	57"	21 $\frac{1}{16}$ "	32 $\frac{1}{16}$ "	1,021 lbs.
3-1943-2	3 Drawer Letter	11 $\frac{1}{16}$ "	12 $\frac{15}{16}$ "	25 $\frac{1}{8}$ "	42 $\frac{13}{16}$ "	19"	31 $\frac{1}{16}$ "	674 lbs.
3-2144-2	3 Drawer Legal	11 $\frac{13}{16}$ "	15 $\frac{1}{4}$ "	26"	43 $\frac{1}{16}$ "	21 $\frac{1}{16}$ "	32 $\frac{1}{16}$ "	651 lbs.
2-1929-2	2 Drawer Letter	11 $\frac{1}{16}$ "	12 $\frac{15}{16}$ "	25 $\frac{1}{8}$ "	29 $\frac{1}{2}$ "	19"	31 $\frac{1}{16}$ "	482 lbs.
2-2130-2	2 Drawer Legal	11 $\frac{13}{16}$ "	15 $\frac{1}{4}$ "	26"	29 $\frac{7}{8}$ "	21 $\frac{1}{16}$ "	32 $\frac{1}{16}$ "	592 lbs.

### FIREKING® PROTECTION PLUS™ FILES



4-2131-C SF	4 Dr Legal Safe-In-A-File	10 $\frac{3}{8}$ "	15 $\frac{1}{4}$ "	26"	52 $\frac{3}{4}$ "	20 $\frac{13}{16}$ "	31 $\frac{1}{16}$ "	728 lbs.
3-2131-C SF	3 Dr Legal Safe-In-A-File	10 $\frac{3}{8}$ "	15 $\frac{1}{4}$ "	26"	40 $\frac{1}{4}$ "	20 $\frac{13}{16}$ "	31 $\frac{1}{16}$ "	644 lbs.
2-2131-C SF	2 Dr Legal Safe-In-A-File	10 $\frac{3}{8}$ "	15 $\frac{1}{4}$ "	26"	27 $\frac{3}{4}$ "	20 $\frac{13}{16}$ "	31 $\frac{1}{16}$ "	501 lbs.
4-1831-C EL	4 Dr Letter Elec. Lock File	10 $\frac{3}{8}$ "	12 $\frac{3}{16}$ "	26"	52 $\frac{3}{4}$ "	17 $\frac{3}{4}$ "	31 $\frac{1}{16}$ "	603 lbs.
4-2131-C EL	4 Dr Legal Elec. Lock File	10 $\frac{3}{8}$ "	15 $\frac{1}{4}$ "	26"	52 $\frac{3}{4}$ "	20 $\frac{13}{16}$ "	31 $\frac{1}{16}$ "	664 lbs.

*Safe-In-A-File: Safe inside dimensions - 10 $\frac{3}{16}$ " H, 16 $\frac{1}{16}$ " W, 24 $\frac{1}{16}$ " D. Safe interiors available in Parchment color only.*

### FIREKING® CARD, CHECK & NOTE FILES



6-2552-C	6 Drawer	6 $\frac{1}{4}$ "	19 $\frac{3}{4}$ "	26"	52 $\frac{3}{4}$ "	25 $\frac{5}{16}$ "	31 $\frac{1}{16}$ "	863 lbs.
4-2536-C	4 Drawer	6 $\frac{1}{4}$ "	19 $\frac{3}{4}$ "	26"	36 $\frac{1}{8}$ "	25 $\frac{5}{16}$ "	28 $\frac{3}{16}$ "	644 lbs.

### FIREKING® STORAGE CABINET



CF7236-F	4 Adjustable Shelves	67 $\frac{7}{8}$ "	31 $\frac{7}{8}$ "	15"	72"	36"	19 $\frac{1}{4}$ "	864 lbs.
CF4436-F	2 Adjustable Shelves	39 $\frac{7}{8}$ "	31 $\frac{7}{8}$ "	15"	44"	36"	19 $\frac{1}{4}$ "	578 lbs.

### SIGNATURE SERIES VERTICAL FILES



2S2130-CSCML	2 Drawer Legal	11 $\frac{13}{16}$ "	15 $\frac{1}{4}$ "	26"	28 $\frac{14}{16}$ "	21 $\frac{1}{4}$ "	31 $\frac{1}{2}$ "	410 lbs.
4S2157-CSCML	4 Drawer Legal	11 $\frac{13}{16}$ "	15 $\frac{1}{4}$ "	26"	57"	21 $\frac{1}{4}$ "	31 $\frac{1}{2}$ "	721 lbs.

### SIGNATURE SERIES LATERAL FILES



4S3122-CSCML	4 Drawer	10 $\frac{3}{8}$ "	25 $\frac{3}{16}$ "	15 $\frac{1}{8}$ "	52 $\frac{3}{4}$ "	31 $\frac{1}{16}$ "	22 $\frac{1}{8}$ "	795 lbs.
4S3822-CSCML	4 Drawer	10 $\frac{3}{4}$ "	31 $\frac{15}{16}$ "	15 $\frac{1}{8}$ "	52 $\frac{3}{4}$ "	37 $\frac{1}{16}$ "	22 $\frac{1}{8}$ "	910 lbs.
4S4422-CSCML	4 Drawer	10 $\frac{3}{4}$ "	38 $\frac{15}{16}$ "	15 $\frac{1}{8}$ "	52 $\frac{3}{4}$ "	44 $\frac{1}{16}$ "	22 $\frac{1}{8}$ "	1,020 lbs.
3S3122-CSCML	3 Drawer	10 $\frac{3}{8}$ "	25 $\frac{3}{16}$ "	15 $\frac{1}{8}$ "	40 $\frac{1}{4}$ "	31 $\frac{1}{16}$ "	22 $\frac{1}{8}$ "	600 lbs.
3S3822-CSCML	3 Drawer	10 $\frac{3}{4}$ "	31 $\frac{15}{16}$ "	15 $\frac{1}{8}$ "	40 $\frac{1}{4}$ "	37 $\frac{1}{16}$ "	22 $\frac{1}{8}$ "	760 lbs.
3S4422-CSCML	3 Drawer	10 $\frac{3}{4}$ "	38 $\frac{15}{16}$ "	15 $\frac{1}{8}$ "	40 $\frac{1}{4}$ "	44 $\frac{1}{16}$ "	22 $\frac{1}{8}$ "	809 lbs.
2S3122-CSCML	2 Drawer	10 $\frac{3}{8}$ "	25 $\frac{3}{16}$ "	15 $\frac{1}{8}$ "	27 $\frac{3}{4}$ "	31 $\frac{1}{16}$ "	22 $\frac{1}{8}$ "	455 lbs.
2S3822-CSCML	2 Drawer	10 $\frac{3}{4}$ "	31 $\frac{15}{16}$ "	15 $\frac{1}{8}$ "	27 $\frac{3}{4}$ "	37 $\frac{1}{16}$ "	22 $\frac{1}{8}$ "	557 lbs.
2S4422-CSCML	2 Drawer	10 $\frac{3}{4}$ "	38 $\frac{15}{16}$ "	15 $\frac{1}{8}$ "	27 $\frac{3}{4}$ "	44 $\frac{1}{16}$ "	22 $\frac{1}{8}$ "	617 lbs.





# WHERE DO YOU STORE YOUR VITAL PAPERS AND RECORDS? HOW DO YOU PROTECT YOUR COMPUTER MEDIA? HOW DO YOU PROTECT YOUR PERSONAL VALUABLES?

## **FIREKING® SAFES MEAN PROTECTION.**

For nearly 50 years, forward-thinking businesses and individuals have relied on **FireKing®** to safeguard their vital records, documents, securities and computer media. By choosing FireKing safes, you too can experience the peace of mind protection brings.

FireKing safes come in an extensive range of styles, sizes, and budgets. So you can be assured of finding a quality safe to meet your exact needs. Our line of **Gary® by FireKing®** safes, though not fireproof, protect all manner of valuables from burglary and theft. And for those who need only to protect documents or vital records, our 1-Hour Fire-Rated Series is an economical solution.

If you'd like additional fire protection, choose from our affordable 2-Hour Fire with Impact Rated Series. Each of these safes carries a UL® Class 350 2-hour fire rating, plus a UL impact rating, which assures you protection in case of ceiling or floor collapse.

For enhanced burglary protection, there are the FireKing 1-Hour Fire and Burglary safes. These safes were the first to earn both a UL Class 350 1-hour fire rating and a UL Residential Security Container (RSC) burglary rating from Underwriters Laboratories.

To meet the extraordinary needs of businesses where sustained fire is a risk, we offer 2-Hour Fire with Impact and Burglary safes, offering a superior level of protection against fire and theft. All of these safes carry the UL 2-hour Fire and Impact label, plus the RSC burglary rating.

We also offer a range of FireKing Data Safes designed to protect sensitive magnetic storage media from heat, humidity, dust and magnetic fields. All carry a UL Class 125 1-, 2-, and 3-hour Fire and Impact rating. These range from our compact mid-size Data Safes to our spacious, high-capacity Data Safes. Select the model that fits your storage protection needs.

**FIREKING® 1-HOUR RATED  
FIRE SAFES**

**FIREKING® 2-HOUR  
FIRE- AND IMPACT-RATED SAFES**



FK1613-1GRE



KV2015-2GRE



*One of three sizes featuring seamless body construction. Vinyl feet prevent scratching.*

**FIREKING® 1-HOUR RATED  
FIRE SAFES**



Model	Interior Size			Exterior Size			Weight	Capacity
	H	W	D	H	W	D		
FK1313-1GRE	13"	13"	10"	17 1/8" *	16 1/8"	16 1/4"	95 lbs.	1.0 cu. ft.
FK1613-1GRE	16"	13"	12 1/2"	21" *	17"	18 1/2"	135 lbs.	1.5 cu. ft.
FK1714-1GRE	16 7/8"	13 1/2"	15"	23" *	18 5/8"	20 7/8"	205 lbs.	2.0 cu. ft.

**FIREKING® 2-HOUR FIRE- AND  
IMPACT-RATED SAFES**



KV1714-2GRE	16 7/8"	13 1/2"	12"	23" *	18 5/8"	20 3/8"	250 lbs.	1.6 cu. ft.
KV2015-2GRE	20"	15"	13 1/4"	26" *	20"	21 1/4"	325 lbs.	2.3 cu. ft.

*See your dealer for the complete selection of interior designs.  
\*Includes feet - 1"*

**FIREKING® 1-HOUR RATED FIRE SAFES**

Designed to provide economical, but uncompromised fire protection for important documents, this series carries a UL® Class 350 1-hour fire rating with an electronic lock, offering excellent fire protection and basic theft security. Available in 3 sizes, in Graphite color only.

**PROTECTS DOCUMENTS FOR AT LEAST ONE HOUR  
IN TEMPERATURES UP TO 1700°.**

These FireKing safes carry the UL Class 350 1-hour fire rating. This means that the internal temperature of the safe will not exceed 350°F for at least one hour when exposed to external temperatures up to 1700°F. This exhaustive testing proves FireKing safes are built to survive the worst conditions.

**FIREKING® 2-HOUR FIRE- AND IMPACT-RATED SAFES**

These are premium home and small office records safes, offering enhanced durability and protection. These economical safes feature a full UL Class 350 2-hour fire rating with impact with an electronic lock. Heavy-duty hinges offer smooth door operation for the life of the safe. These safes provide important security features such as 3-way boltwork and a UL-listed relocking device with an integrated door hardplate. They offer you complete peace of mind for your important personal documents, at a most affordable price. Available in 2 sizes, in Graphite color only.

## FIREKING® 1-HOUR FIRE- AND BURGLARY-RATED SAFES



**FB5428-1**  
*Shown in Graphite with  
optional electronic lock*



*Comes standard  
with four shelves.*



**FB1612-1**  
*Shown in Taupe with  
optional electronic lock*



*For added security, a 7/8"  
anchor hole comes standard  
in the bottom of the safe.*

### FIREKING® 1-HOUR FIRE- AND BURGLARY-RATED SAFES



Model	Interior Size			Exterior Size			Weight	Capacity
	H	W	D	H	W	D		
FB1612-1	16"	12"	12¼"	21 <sup>5</sup> / <sub>16</sub> "	17 <sup>13</sup> / <sub>16</sub> "	21 <sup>5</sup> / <sub>16</sub> "	330 lbs.	1.3 cu. ft.
FB2218C1	22"	18 <sup>5</sup> / <sub>8</sub> "	12¼"	27 <sup>5</sup> / <sub>16</sub> "	24 <sup>7</sup> / <sub>16</sub> "	21 <sup>5</sup> / <sub>16</sub> "	590 lbs.	2.9 cu. ft.
FB2218-1	22"	18 <sup>5</sup> / <sub>8</sub> "	16"	27 <sup>5</sup> / <sub>16</sub> "	24 <sup>7</sup> / <sub>16</sub> "	25 <sup>3</sup> / <sub>4</sub> "	620 lbs.	3.8 cu. ft.
FB3020-1	30"	20"	21"	35 <sup>5</sup> / <sub>16</sub> "	25 <sup>13</sup> / <sub>16</sub> "	30 <sup>3</sup> / <sub>4</sub> "	915 lbs.	7.3 cu. ft.
FB3624-1	36"	24"	21"	41"	29 <sup>13</sup> / <sub>16</sub> "	30 <sup>3</sup> / <sub>4</sub> "	1,040 lbs.	10.5 cu. ft.
FB4524-1	45"	24"	21"	50 <sup>5</sup> / <sub>16</sub> "	29 <sup>13</sup> / <sub>16</sub> "	30 <sup>3</sup> / <sub>4</sub> "	1,140 lbs.	13.1 cu. ft.
FB5428-1	54 <sup>3</sup> / <sub>4</sub> "	28 <sup>5</sup> / <sub>16</sub> "	19 <sup>7</sup> / <sub>8</sub> "	60 <sup>5</sup> / <sub>16</sub> "	34 <sup>1</sup> / <sub>16</sub> "	29 <sup>7</sup> / <sub>8</sub> "	1,240 lbs.	17.8 cu. ft.

*See your dealer for the complete selection of interior designs.*

### FIREKING® 1-HOUR FIRE- AND BURGLARY-RATED SAFES

These safes carry both a UL® Class 350 1-hour fire rating and a UL RSC burglary rating. You might expect to pay hundreds, even thousands, more for a safe so tough. However, using today's most advanced technology, FireKing is able to offer these dual-labeled safes at a very affordable price. You don't have to sacrifice protection or pay more for the security they offer. Available in 7 sizes and 2 colors, Graphite or Taupe.

### FEATURES:

- UL-listed relocking device for extra security
- Drill-resistant steel hardplate protects the combination lock
- Vertical and horizontal bolts resist prying
- Bolt-O-Matic door guard automatically extends the 1" bolts when the door is closed
- UL-rated Group II combination lock is standard with over 1,000,000 combinations
- Optional Sargent & Greenleaf electronic lock automatically locks safe when door is closed
- 7/8" anchor hole in bottom of safe comes standard for added security

**FIREKING® 2-HOUR FIRE WITH IMPACT AND BURGLARY-RATED RECORD SAFES**

**KR5021-2**  
Shown in Taupe with optional electronic lock

**KR2115-2**  
Shown in Graphite with optional electronic lock



Equipped with 2 standard adjustable shelves and extra hardplate for enhanced drill resistance. All have a UL® fire and impact label, a UL® RSC burglary label and a high-security Medeco® key lock.



Three shelves are standard.

**SPECIFICATIONS**

Model	Interior Size			Exterior Size			Weight	Capacity
	H	W	D	H	W	D		
KR2115-2	20"	18½"	15"	30¾"	25½"	22⅞"	420 lbs.	3.2 cu. ft.
KR2021-2	20"	18½"	21"	30¾"	25½"	28⅞"	560 lbs.	4.5 cu. ft.
KR3115-2	30⅛"	18½"	15"	41⅞"	25½"	22⅞"	525 lbs.	4.9 cu. ft.
KR3121-2	30⅛"	18½"	21"	41⅞"	25½"	28⅞"	635 lbs.	6.9 cu. ft.
KR3921-2	39½"	18½"	21"	49⅞"	25½"	28⅞"	760 lbs.	8.9 cu. ft.
KR5021-2	50"	18½"	21"	60½"	25½"	28⅞"	875 lbs.	11.2 cu. ft.

See your dealer for the complete selection of interior designs.

**FIREKING® 2-HOUR FIRE WITH IMPACT AND BURGLARY-RATED RECORD SAFES**



**UL® 2-HOUR FIRE WITH IMPACT AND BURGLARY SAFES**

If you have reason to be extraordinarily serious about security, FireKing 2-Hour Fire and Burglary Safes are perfect for you. They are designed to offer superior fire and burglary protection. All 6 sizes carry a UL Class 350 2-hour fire rating, and all have passed UL's impact test.\* All meet stringent security testing and carry a UL RSC burglary label and a UL-listed relocker. Available in 6 sizes and 2 colors, Graphite or Taupe.

\*The UL impact test calls for the safe to be heated to 1550°F for 30 minutes (1638°F for 45 minutes for a 2-hour fire-rated safe) then dropped onto concrete rubble from a height of 30 feet. Then it is inverted and reheated for another 30 minutes (45 minutes for a 2-hour fire-rated safe). The safe must maintain its integrity throughout the test and protect all contents. Why is impact testing important? In many fires, roofs will cave in or the floor will collapse, destroying everything under them. In such an event, you'll want to know your safe is impact-rated.

Underwriters Laboratories and UL are registered trademarks of Underwriters Laboratories and are used with permission.

**FIREKING® MIXED MEDIA SAFE**



Safe shown with optional interiors sold separately.

**MEDIA COMPARTMENT  
OPTIONAL INTERIORS**

- CM19-FS Fixed shelf
- CM19-CD Composite drawer

**PAPER COMPARTMENT  
OPTIONAL INTERIORS**

- S-21 Fixed shelf

**FIREKING® MEDIAVAULT™**



**CAPACITY GUIDE**

- 3.5" Diskettes ..... 130
- 4mm DAT ..... 60
- 8mm DAT ..... 30
- CDR/DVDR ..... 40
- DLT ..... 12\*\*
- 3480/3590 ..... 9
- ZIP® Disk 100 ..... 31

\*\*Without plastic sleeves.

FireKing 1-Hour UL® Class 125 Fire Rating.

**SPECIFICATIONS**

Model	Interior Size			Exterior Size			Weight	Capacity
	H	W	D	H	W	D		
<b>DP2150-M</b>								
Paper compartment	19½"	26¾"	20 <sup>23</sup> / <sub>32</sub> "	59¾"	32 <sup>1</sup> / <sub>16</sub> "	31" *	1,290 lbs.	6.1 cu. ft.
Media compartment	24 <sup>5</sup> / <sub>16</sub> "	18 <sup>5</sup> / <sub>16</sub> "	16 <sup>1</sup> / <sub>16</sub> "					4.4 cu. ft.

\*Exterior depth does not include handle depth of 1¾".

**FIREKING®  
MIXED MEDIA SAFE**



**FIREKING® MEDIAVAULT™**



**MV1000**

5¾"	6¼"	8¾"	10½"	11¾"	17½"	74 lbs.	.2 cu. ft.
-----	-----	-----	------	------	------	---------	------------

**FIREKING® MIXED MEDIA SAFE**

The Mixed Media Safe from FireKing offers the ultimate in versatile protection – because it’s really two safes in one. The top section is a UL® Class 350 1-Hour Impact Rated safe with over 6 cubic feet of storage for your important paper records and files. The bottom is a UL Class 125 3-Hour Impact Rated data media compartment to hold your CDs, tapes, discs and other media. Available in our Platinum finish.

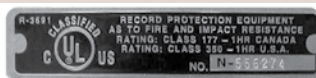

**FIREKING® MEDIAVAULT™**

The MediaVault from FireKing is a compact, affordable, stand-alone storage safe that is designed to protect heat-sensitive valuables, including data and information storage media. Whether it’s microfiche, photographs or computer data on virtually any standard media (see above), the MediaVault will protect it from dust and fires of up to 1700°F. The MediaVault is the only compact and affordable media safe of its size designed to meet Underwriters Laboratories® (UL®) Class 125, one-hour specification for insulated records protection equipment. This specification ensures that the interior temperature of the storage device does not exceed 125°F when exposed to a fire of 1700°F for a period of one hour and during that time the interior relative humidity does not exceed 85%RH. The MediaVault is equipped with a key lock conveniently located on the lid for added security.

## FIREKING® 1-HOUR DATA SAFES



Safe shown with Composite Drawers and Fixed Shelves (sold separately).

### TEST PROCEDURE

\*Maintain an interior temperature less than 125 °F and an interior relative humidity less than 80% for Class 125, when exposed to fire as per the Standard Time Temperature Curve for 1 hour to 1700 °F. Successfully undergo all other requirements for the Fire Endurance Test, the Explosion Hazard Test, the Humidity Test and the Fire and Impact Test.

### OPTIONAL INTERIORS

- CS12-FS Fixed shelf for DS1513-1
- CS12-CD Composite drawer for DS1513-1
- CS16-FS Fixed shelf for DS1817-1
- CS16-CD Composite drawer for DS1817-1
- CC31-FS Adjustable shelf for DC3531-1†
- CC31-CD Composite drawer for DC3531-1†

†DC3531 is not Impact Rated.



## FIREKING® 1-HOUR FIRE WITH IMPACT-RATED DATA SAFES

A wide range of interiors for storing magnetic media make these safes a versatile and economical choice. Computer media is easily damaged. Manufacturers recommend storing magnetic media at a temperature below 125 °F and at a humidity level under 80%. Even a hot mug of coffee represents a real hazard, so imagine what a fire would do. In a FireKing Data Safe, computer media is protected from fire, dust, magnetic fields, unauthorized access, accidental damage and electrostatic discharge. Models DS1513 and DS1817 both carry a UL® Class 125 1-hour fire and impact rating.\*

### FEATURES:

- Equipped with a high-security key lock
- Safe is offered in our attractive Platinum color

## FIREKING® 2-HOUR DATA SAFES



DS6420

Safe shown with Composite Drawers and Fixed Shelves (sold separately).

### TEST PROCEDURE

\*Maintain an interior temperature less than 125 °F and an interior relative humidity less than 80% for Class 125, when exposed to fire as per the Standard Time Temperature Curve for 2 hours to 1850 °F. Successfully undergo all other requirements for the Fire Endurance Test, the Explosion Hazard Test, the Humidity Test and the Fire and Impact Test.

### OPTIONAL INTERIORS

- CS20-FS Fixed shelf for DS2320/3420/4520/6420-2
- CS20-CD Composite drawer for DS2320/3420/4520/6420-2
- CS31-FS Fixed shelf for DS6431-2
- CS31-CD Composite drawer for DS6431-2



## FIREKING® 2-HOUR FIRE WITH IMPACT-RATED DATA SAFES

An ideal way to store all types of magnetic media and protect them against fire, dust and accidental damage, they are available in 5 sizes to accommodate your storage needs. These affordable safes provide the ultimate in protection by incorporating layers of heat-absorbing material, fireproof insulating foam and fireproofing with a tough steel casing. Three-way boltwork ensures that doors remain shut if a building collapses during a fire or if a forced entry is attempted. Each FireKing 2-Hour Safe carries a UL® Class 125 2-hour fire and impact rating.\*

### FEATURES:

- Programmable electronic lock for security and easy access
- Safe is offered in our attractive Platinum color
- Optional interiors allow various configurations to meet your storage needs

## FIREKING® 3-HOUR DATA SAFES

Safe shown with Composite Drawers and Fixed Shelves (sold separately).



DM4420

### TEST PROCEDURE

\*Maintain an interior temperature less than 125 °F and an interior relative humidity less than 80% for Class 125, when exposed to fire as per the Standard Time Temperature Curve for 3 hours to 1925 °. Successfully undergo all other requirements for the Fire Endurance Test, the Explosion Hazard Test, the Humidity Test and the Fire and Impact Test.

### OPTIONAL INTERIORS

- CM12-FS Fixed shelf for DM1413/2513-3
- CM12-CD Composite Drawer for DM1413/2513-3
- CM19-FS Fixed shelf for DM2520/3420/4420-3
- CM19-CD Composite Drawer for DM2520/3420/4420-3



### SPECIFICATIONS

Model	Interior Size			Exterior Size			Weight	Capacity
	H	W	D	H	W	D		
DS1513-1	14 <sup>3</sup> / <sub>8</sub> "	12 <sup>7</sup> / <sub>10</sub> "	12 <sup>7</sup> / <sub>10</sub> "	25 <sup>1</sup> / <sub>2</sub> "	21 <sup>1</sup> / <sub>2</sub> "	22 <sup>3</sup> / <sub>8</sub> "	297 lbs.	1.3 cu. ft.
DS1817-1	17 <sup>7</sup> / <sub>8</sub> "	16 <sup>3</sup> / <sub>8</sub> "	17"	28 <sup>3</sup> / <sub>8</sub> "	25 <sup>1</sup> / <sub>2</sub> "	26 <sup>3</sup> / <sub>8</sub> "	429 lbs.	2.8 cu. ft.
DC3531-1†	27 <sup>3</sup> / <sub>4</sub> "	23 <sup>3</sup> / <sub>4</sub> "	18 <sup>7</sup> / <sub>8</sub> "	34 <sup>7</sup> / <sub>8</sub> "	30 <sup>7</sup> / <sub>8</sub> "	27 <sup>1</sup> / <sub>8</sub> "	640 lbs.	7.0 cu. ft.
<i>†DC3531 is not Impact Rated.</i>								
DS2320-2	22 <sup>1</sup> / <sub>2</sub> "	19 <sup>5</sup> / <sub>16</sub> "	15 <sup>13</sup> / <sub>16</sub> "	36 <sup>1</sup> / <sub>8</sub> "	29 <sup>7</sup> / <sub>16</sub> "	30"	680 lbs.	4.0 cu. ft.
DS3420-2	33 <sup>3</sup> / <sub>16</sub> "	19 <sup>5</sup> / <sub>16</sub> "	15 <sup>13</sup> / <sub>16</sub> "	47 <sup>3</sup> / <sub>16</sub> "	29 <sup>7</sup> / <sub>16</sub> "	30"	880 lbs.	5.9 cu. ft.
DS4520-2	44 <sup>9</sup> / <sub>16</sub> "	19 <sup>5</sup> / <sub>16</sub> "	15 <sup>13</sup> / <sub>16</sub> "	58 <sup>1</sup> / <sub>4</sub> "	29 <sup>7</sup> / <sub>16</sub> "	30"	1,070 lbs.	7.9 cu. ft.
DS6420-2	63 <sup>1</sup> / <sub>8</sub> "	19 <sup>5</sup> / <sub>16</sub> "	15 <sup>13</sup> / <sub>16</sub> "	76 <sup>13</sup> / <sub>16</sub> "	29 <sup>7</sup> / <sub>16</sub> "	30"	1,380 lbs.	11.2 cu. ft.
DS6431-2	63 <sup>1</sup> / <sub>8</sub> "	30 <sup>3</sup> / <sub>4</sub> "	18 <sup>5</sup> / <sub>16</sub> "	76 <sup>13</sup> / <sub>16</sub> "	40 <sup>7</sup> / <sub>8</sub> "	32 <sup>3</sup> / <sub>16</sub> "	1,870 lbs.	20.9 cu. ft.
<i>See your dealer for the complete selection of interior designs.</i>								
DM1413-3	13 <sup>5</sup> / <sub>8</sub> "	11 <sup>1</sup> / <sub>2</sub> "	16 <sup>11</sup> / <sub>16</sub> "	29 <sup>5</sup> / <sub>8</sub> "	25 <sup>1</sup> / <sub>4</sub> "	31"	650 lbs.	1.5 cu. ft.
DM2513-3	24 <sup>5</sup> / <sub>16</sub> "	11 <sup>1</sup> / <sub>2</sub> "	16 <sup>11</sup> / <sub>16</sub> "	40 <sup>1</sup> / <sub>4</sub> "	25 <sup>1</sup> / <sub>4</sub> "	31"	740 lbs.	2.7 cu. ft.
DM2520-3	24 <sup>5</sup> / <sub>16</sub> "	18 <sup>5</sup> / <sub>8</sub> "	16 <sup>11</sup> / <sub>16</sub> "	40 <sup>1</sup> / <sub>4</sub> "	32 <sup>1</sup> / <sub>16</sub> "	31"	1,050 lbs.	4.5 cu. ft.
DM3420-3	33 <sup>1</sup> / <sub>8</sub> "	18 <sup>5</sup> / <sub>8</sub> "	16 <sup>11</sup> / <sub>16</sub> "	49 <sup>1</sup> / <sub>16</sub> "	32 <sup>1</sup> / <sub>16</sub> "	31"	1,240 lbs.	6.0 cu. ft.
DM4420-3	43 <sup>3</sup> / <sub>8</sub> "	18 <sup>5</sup> / <sub>8</sub> "	16 <sup>11</sup> / <sub>16</sub> "	59 <sup>3</sup> / <sub>4</sub> "	32 <sup>1</sup> / <sub>16</sub> "	31"	1,420 lbs.	7.9 cu. ft.

*†Exterior depth does not include handle depth of 1<sup>1</sup>/<sub>4</sub>".*

### FIREKING® 1-HOUR FIRE WITH IMPACT-RATED DATA SAFES



### FIREKING® 2-HOUR FIRE WITH IMPACT-RATED DATA SAFES



### FIREKING® 3-HOUR FIRE WITH IMPACT-RATED DATA SAFES



### FIREKING® 3-HOUR FIRE WITH IMPACT-RATED DATA SAFES

The ultimate in protection against fire, dust, electrostatics and accidental damage for your computer media, our highest rated safes are perfect for businesses with large-capacity electronic storage needs. FireKing 3-Hour Data Safes are available in 5 sizes, all featuring the UL® Class 125 3-hour fire and impact rating\*, plus the UL Residential Security Container (RSC) Burglary Rating for tough protection against break-in.

#### FEATURES

- Programmable electronic lock for security and easy access
- Safe is offered in our attractive Platinum finish
- UL RSC Burglary Rating
- UL Class 125 3-Hour Fire and Impact Rating
- Canadian UL Class 52 3-Hour as to fire and impact resistance

## GARY® BY FIREKING®

### DEPOSITORY SAFE FB2114-RE



- Created to handle the needs of retailers
- 3/8" door, formed-steel body with front loading hopper
- All models available with key and/or combination (dial or electronic) locks
- The compact size of single door models permits under-counter installation

### EXECUTIVE SAFE EX0915



- Cover opens automatically when you enter your security code – no more fumbling with locks or keys
- Light enough to be easily carried, can be conveniently taken along on business or personal travels
- Two mounting plates included, allowing you to secure valuables in your desk, car or nearly any location; additional mounting plates may be purchased
- Simple mounting system allows you to install mounting plates on a variety of surfaces, including wood and concrete; easily removed from the mounting plates by anyone with a proper entry code
- When lock is closed, any incorrect entry code will be rejected. If an incorrect code is entered, a buzzer alarm will sound. A third incorrect code entry starts a 5-minute timer, during which no codes will be accepted. At the end of the 5-minute timer, a correct user code will be allowed.
- When any key is pressed, the entire keypad lights up, making access easy – even in low-light situations
- Operates on 4 AA/1.5V batteries
- Features an automatic "low battery" alarm and mechanical override key

## SPECIFICATIONS

Model	Interior Size			Exterior Size			Weight	Capacity
	H	W	D	H	W	D		
FB2114-RC	12"	12"	12"	21"	14"	14"	97 lbs.	1.6 cu. ft.
FB2114-RK	12"	12"	12"	21"	14"	14"	97 lbs.	1.6 cu. ft.
FB2114-RE	12"	12"	12"	21"	14"	14"	97 lbs.	1.6 cu. ft.
EX0915	2 3/4"	7 3/4"	10 1/4"	3 1/2"	9"	15"	16.5 lbs.	

### GARY® DEPOSITORY SAFE WITH FRONT-PULL HOPPER



### GARY® EXECUTIVE SAFE



#### GARY® DEPOSITORY SAFES

Our Depository Safes feature a 3/8" door and formed-steel body, and are available in single- and dual-compartment models, with three drop options and several key and combination lock options. A very smart buy and reliable protection from theft and robbery.

#### GARY® EXECUTIVE SAFE

Compact, portable and incredibly tough, the Gary Executive Safe is a must-have for any business executive. With the Executive Safe, you can securely store items inside a desk drawer – your PDA, cell phone, watch, computer discs, files and other valuables. The handy mounting system allows the safe to be easily moved from desk drawer to car trunk or nearly any location. And once the safe is locked into place, only those with the proper entry code can open it or move it. Other features include lighted keypad, low-battery alarm, and timed system shutdown after the third incorrect code is entered. With the Gary Executive Safe, you can feel safe in your office, or on the go.



# GARY® BY FIREKING®

## LAPTOP SAFE LT1507



- Designed to offer secure protection for laptop computers and other valuable possessions
- Compact size allows easy installation on the wall or floor in home, dorm room, office – even in your automobile
- Electronic key lock provides security and easy access (batteries included); equipped with four-bit mechanical key for emergency
- Tough construction with a pry-resistant door and durable finish
- Available in Light Gray

## PERSONAL SAFE HS1207





- Offers big protection in a compact size; ideal for home, office, workstations, automobile – anywhere you need valuables protected
- Bolt-Down Kit (included) easily attaches safe to the wall or floor
- Digital keypad with 3- to 8-digit programmable code entry provides security and easy access (batteries included)
- Manual override keys for emergencies
- Tough 9-gauge construction on door and 14-gauge walls resist burglary and break-ins

## TRIM SAFE MS1206



- Ideal for cash-based businesses
- Compact size and easily mounted
- Installation allowed near cash registers to permit frequent cash drops
- Key lock
- Slot dimensions: 5<sup>3</sup>/<sub>8</sub>" w. x 5<sup>5</sup>/<sub>8</sub>" h.

### SPECIFICATIONS

Model	Interior Size			Exterior Size			Weight	Capacity	Thickness of Steel	
	H	W	D	H	W	D			Body	Door
<b>GARY® LAPTOP SAFE</b>  LT1507	7 <sup>7</sup> / <sub>16</sub> "	15 <sup>1</sup> / <sub>2</sub> "	14 <sup>7</sup> / <sub>8</sub> "	7 <sup>7</sup> / <sub>16</sub> "	15 <sup>3</sup> / <sub>4</sub> "	16 <sup>5</sup> / <sub>8</sub> "	34 lbs.	1.2 cu. ft.	14-gauge .08/2mm	3-gauge .24"/6mm
<b>GARY® PERSONAL SAFE</b>  HS1207	7 <sup>1</sup> / <sub>2</sub> "	12"	5 <sup>3</sup> / <sub>4</sub> "	7 <sup>3</sup> / <sub>4</sub> "	12 <sup>1</sup> / <sub>4</sub> "	7 <sup>3</sup> / <sub>4</sub> "	19 lbs.	.3 cu. ft.	14-gauge	9-gauge
<b>GARY® TRIM SAFE</b>  MS1206	10 <sup>5</sup> / <sub>8</sub> "	6"	6"	12"	6"	7"	15 lbs.	.2 cu. ft.		

### GARY® PERSONAL AND LAPTOP SAFES

Gary offers big protection in a compact size. Gary's Personal Safe is ideal for home, office, vehicle, or anywhere you need to keep valuables protected; Gary's Laptop Safe is specially designed to protect laptop computers and other small valuables. Both feature a digital keypad with programmable code entry for security and easy access, are equipped with a mechanical key lock for emergency backup entry, and install easily to the wall or floor.

### GARY® TRIM SAFE

For reliable protection from theft and robbery, you'll do very well to choose the Gary Trim Safe. It is ideal for cash-based retail businesses, with a compact profile that installs easily near cash registers to permit frequent cash drops and limit your exposure to robbery.

MUSEUM OF MODERN ART  
11 W. 53 ST NY, NY  
25 MARCH 1977 MAY 17



## SAFETY RATINGS



### Underwriters Laboratories® (UL®)

UL is internationally recognized for conducting the most comprehensive tests in the world. For maximum records protection, a fire- and/or impact-rated safe by UL has been renowned as the best since 1923. Contractors, building and fire inspectors, and other code authorities all seek out the UL Mark as confirmation of the highest level of security. In addition to being tested to withstand falls and fire, UL-rated safes can also survive a wide variety of attacks with both hand and power tools.

#### FIRE RATINGS

Fire ratings for protecting paper are evaluated by conditioning safes to withstand varying furnace heat for specific amounts of time. For example, the UL Class 350 1-hour fire rating means that the internal temperature of the safe will not exceed 350° F for at least 1 hour when exposed to external temperatures over 1700° F. A safe may have a 1-, 2-, or 3-hour time classification.

#### MEDIA RATINGS

The UL Class 125 Rating for media protection means the safe must maintain an interior temperature less than 125° F and an interior relative humidity less than 80%. This classification will ensure protection for any electronic media such as digital discs, computer storage discs, and even microfiche. A safe may have a 1-, 2-, or 3-hour time classification.

#### IMPACT RATINGS

These tests call for the safe to be heated to 1550° F for 30 minutes then dropped onto concrete rubble from a height of 30 feet within 2 minutes of leaving the furnace. Then it is inverted and reheated for another 30 minutes. An explosion test may also be administered to certain models, which leaves the safe in a 2000° F furnace for 30 minutes. It is then inspected for heat or moisture damage.

#### RSC BURGLARY RATING

A Residential Security Container (RSC) is tested to withstand five full minutes of rigorous prying, drilling, punching, chiseling, and tampering attacks by UL technicians. RSCs come in a B Rating (doors less than 1" thick and a body construction less than ½" thick) and a C Rating (doors at least 1" thick and a body construction at least ½" thick.) Both versions are constructed of steel.



A member of the **FireKing**® Security Group.

**1-800-457-2424**